

# EXCESS 11



**XCS**  
*Excess*













# THE WORLD HAS CHANGED, AND SO HAS SAILING.

The **Beneteau family shipyard**, founded in 1884 in Saint-Gilles-Croix-de-Vie in **Vendée** (France), has evolved with the times over decades.

For over 140 years, the men and women of the Beneteau Group have developed a passion for products, a sense of innovation and a constant commitment to customers and the environment.

The **Excess** brand was created 4 years ago to offer those who seek the comfort of a **catamaran** and combined with **sensations of sailing**.







# SEEK SENSATIONS

At Excess, **breaking new ground** isn't revolutionary. It's simply what we do. Unique cruising catamarans with a **dynamic design and our disruptive attitude** set us apart.

This is how we offer **the thrill of sailing without sacrificing comfort**. Thereby, we are your gateway for exciting activities on, in, and around the sea.

Created for sailors looking for their next adventure.













# Excess 11



The Excess 11 is a lively sailing catamaran which does not sacrifice the comfort and volume attributes needed for enjoyable cruising.



**NAVAL ARCHITECT**  
VPLP design

This is the synthesis of the Excess spirit: a beautiful, simple, comfortable boat, with a generous sail plan!



**INTERIOR DESIGNER**  
Nauta Design

Available in 3 and 4 cabins versions.

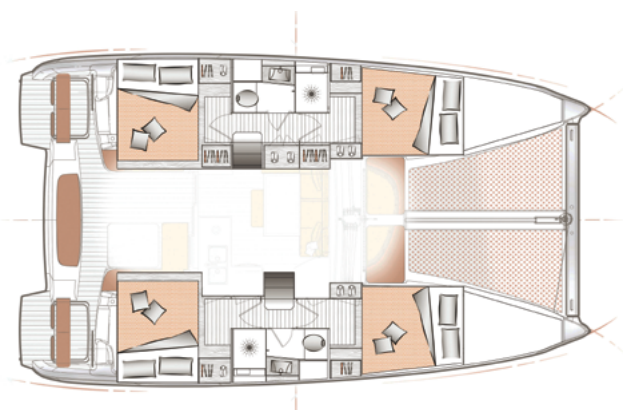
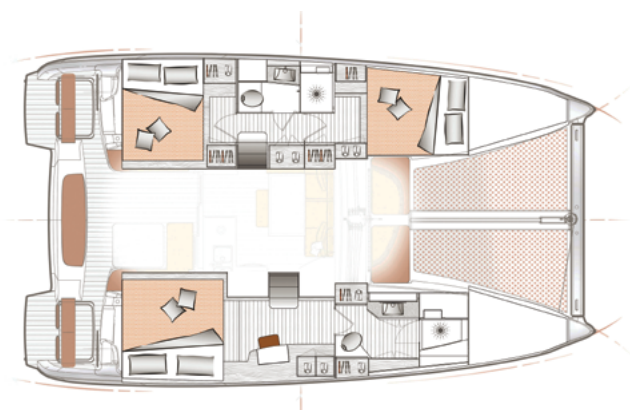





Overall Length	<b>11,42 m / 37'6"</b>
Hull Length	<b>11,33 m / 37'2"</b>
Beam	<b>6,59 m / 21'7"</b>
Mast clearance (std/pulse)	<b>17.27 m   56'7" / 18.26 m   59'1"</b>
Draft	<b>1,15 m / 3'9"</b>
Light displacement	<b>9 T / 19,845 lbs</b>
EC certification	<b>A: 8 - B: 12 - C: 16 - D: 20</b>



Square top mainsail	<b>55 m<sup>2</sup> / 592 sq.ft</b>
Overlapping genoa	<b>32.5 m<sup>2</sup> / 349.8 sq.ft</b>
Code 0 (option)	<b>54 m<sup>2</sup> / 581 sq.ft</b>
Upwind sail area	<b>90 m<sup>2</sup> / 968.8 sq.ft</b>

## PULSE LINE

The choice for bold sailors  
Seeking sensations

Upwind sail area **95.5 m<sup>2</sup> / 1028 sq.ft**



**2 x 200 L**  
2 x 53 US gal



**2x29 HP**



**300 L + 300 L (opt)**  
79 US gal + 79 US gal (opt)



**2 x 80 L**  
2 x 21 US gal



**6 to 12**

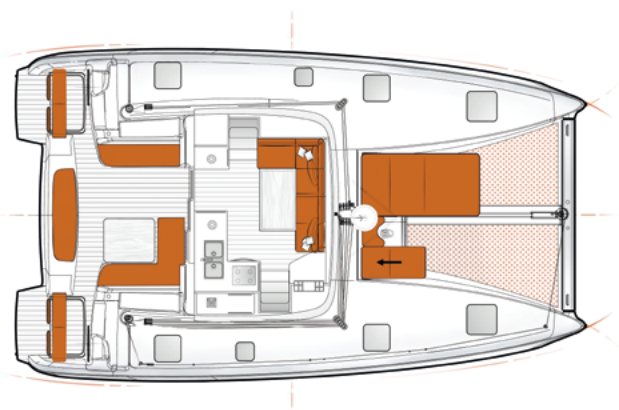
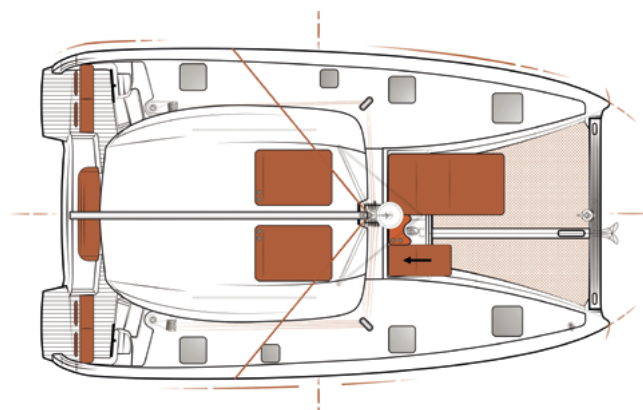

















*Excess 11*







# OUR DISTRIBUTION NETWORK

The Excess distribution network covers the entire world, partnering with selected individuals that are dedicated to excellence and customer satisfaction. Our Excess distributors, located in all key destinations, are there to help you discover our catamarans and accompany you on your adventure at sea.





Find your  
local Excess  
Expert !

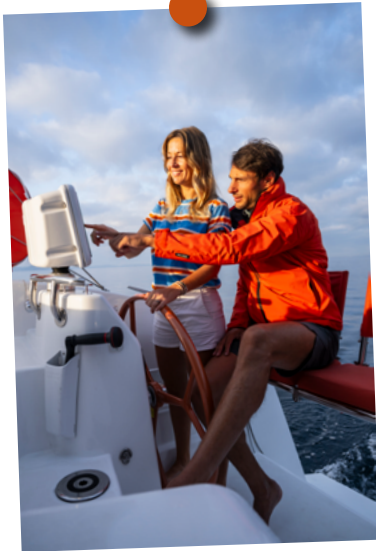





# MEET THE TRIBE

We are young at heart: we enjoy taking new ideas on board or even pioneer new concepts in sailing. And we don't want to do this alone! Excess is a community of Owners, Dealers, Partners, enthusiasts, experts and all together we are the Excess tribe.

We collaborate, we exchange, we share, we question each other, we don't have all the answers but we build together the catamaran world that we dream of.

**Welcome to the Excess tribe !**







«The **Excess Campus**»  
is an unmissable  
event for all **sailing**  
**enthusiasts**.



These **exclusive training** seminar  
allow us to share our knowledge  
and experience with our clients and  
professionals of the nautical industry,  
and to connect with the members of  
the Excess tribe, who have a common  
passion for the sea.







# JOIN THE EXCESS LAB

The Excess Lab gives you the opportunity to join our Design Team, to interact with our specialists and naval architects. You will discover the features we are currently working-on and will be invited to join in the decision making process when selecting the options we will feature on our next Excess catamarans.

The Excess Lab also allows you to post your suggestions and to share the topics you would like our Team to investigate or develop.

*"We are convinced that connecting you, sailors, with our professional team will be an enriching experience for all. It will bring us a lot, no doubt. We certainly hope that you will love and appreciate this sharing of ideas as well!"*

Thibaut de Montvalon, Excess Director



DESIGN THE CATAMARANS OF TOMORROW

*Share your ideas.*

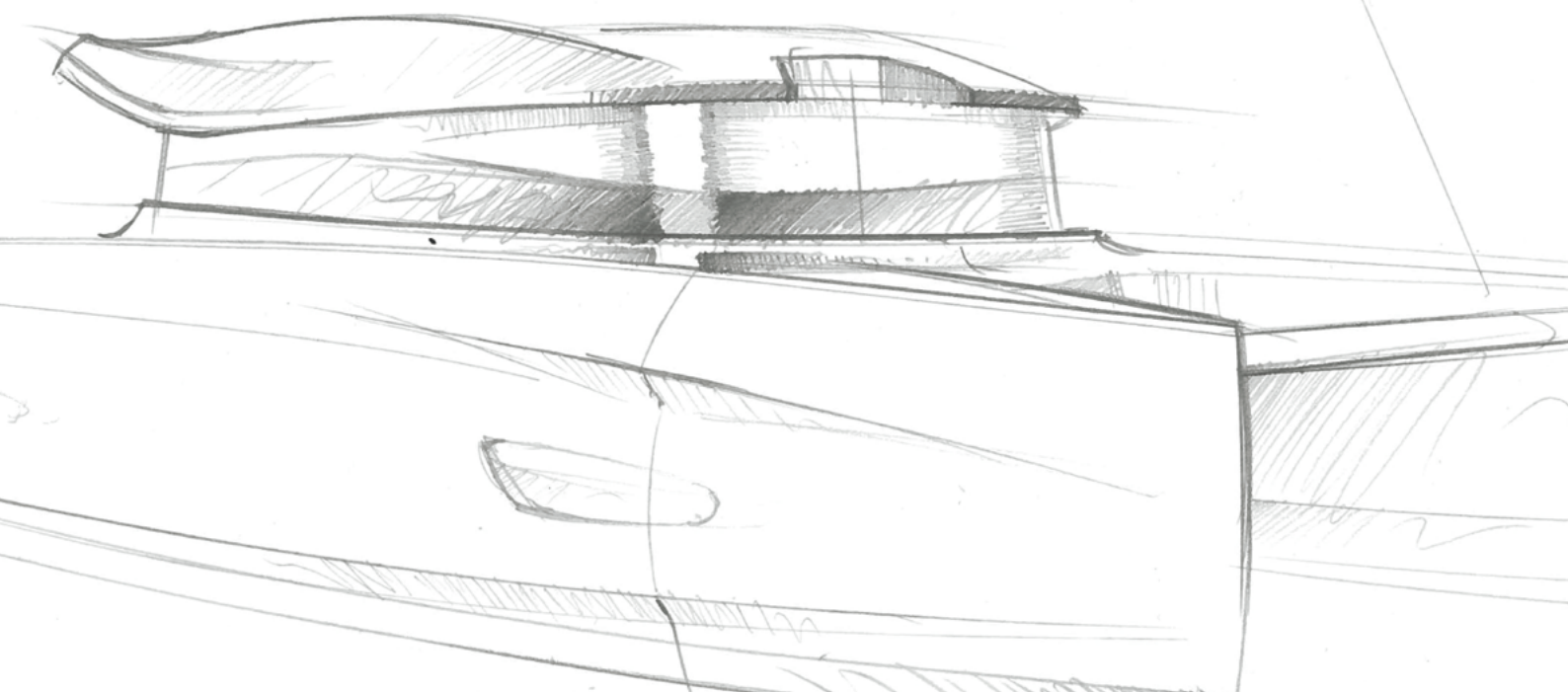





# MY EXCESS

« Join us on My Excess, an online rubric specifically designed for Excess catamaran owners and enthusiasts. As a member of My Excess, you will access exclusive information, receive invitations to special preview events and benefit from our partners' exclusive offers.

My Excess is not only a online platform; it is a dynamic community that celebrates a passion for sailing and adventure. Step on board and explore a universe where each detail has been designed to enhance your experience as a member of the Excess tribe.

**Welcome to My Excess!**

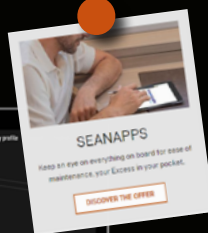
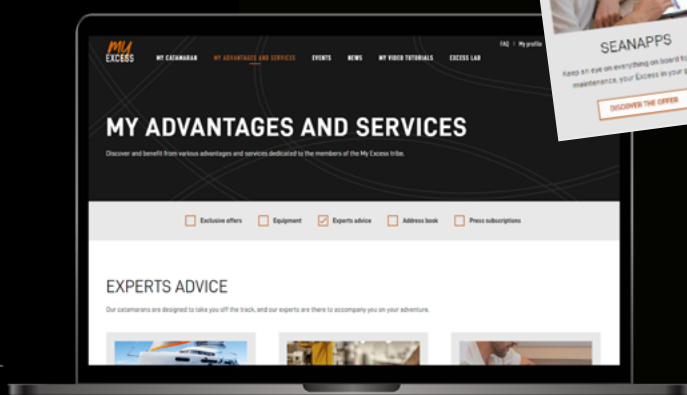





# LESS IS MORE

In accordance with our DNA, at Excess we believe that the best way to be on the water, for us and our planet, is under sail! That's exactly why we want to design cruising catamarans with larger sail plans and reduced weight, capable of sailing under all conditions.

We look for simple and smart solutions in order to offer the necessary comfort and functions on board, while reducing our environmental impact.

**LESS**

**MATERIALS  
CONSUMPTION  
ENERGY  
WASTE  
TRANSFORMATION  
RESSOURCE COLLECTION**

**MORE**

**SUSTAINABILITY  
RELIABILITY  
SOBRIETY**

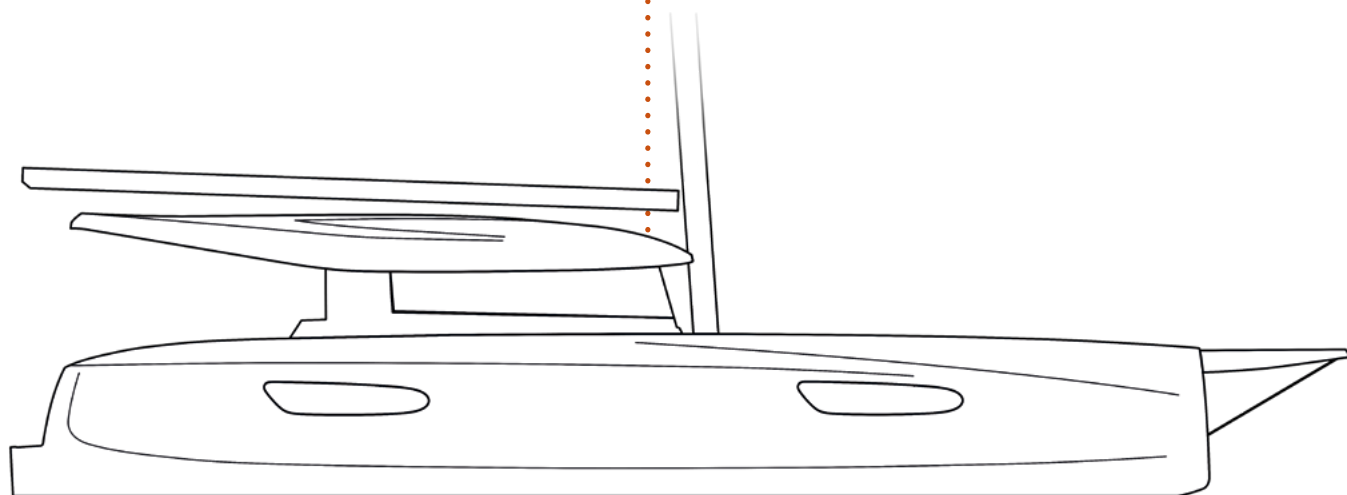



A photograph of several clear PET bottles with blue caps, lying on a solid orange background. The bottles are slightly crumpled and overlapping.

On the Excess 14, our primary coring material is PET foam, which is made from 100% recycled bottles

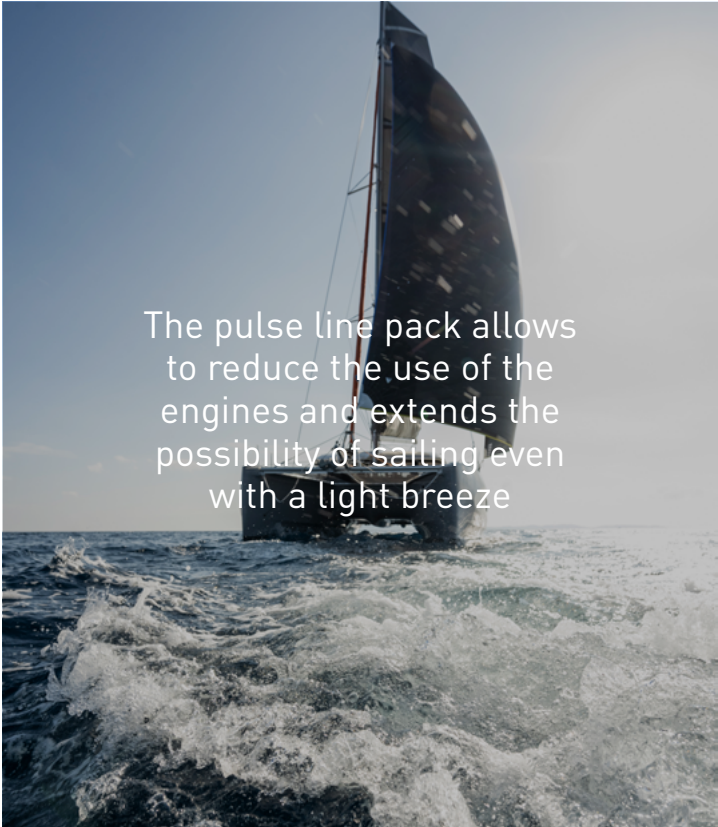
A photograph of a sailboat with a dark sail, sailing on a choppy blue sea under a clear sky. The boat is moving away from the viewer, leaving a white wake.

The pulse line pack allows to reduce the use of the engines and extends the possibility of sailing even with a light breeze

A close-up photograph of a white boat's interior, showing a grey electric propulsion control panel with a digital display and a red emergency stop button. A red steering wheel is partially visible on the right.

In 2021, we launched our first Excess prototype with an electric propulsion: the Excess 15 «E'Lab»

A photograph showing a close-up of a boat's interior structure, featuring a woven pattern of natural fibers, likely hemp, used in the construction of the hull or deck.

We are progressively introducing natural fibers, such as hemp, in the built process of our boats. In 2023, Groupe Beneteau mould over 30.000 GRP parts using bio-sourced resins with natural core materials

A photograph looking up at the canopy of a dense forest, with many tall, thin tree trunks reaching towards a bright, green sky.

In 2023, 38% of the resin used to build our catamarans are bio sourced.





# EXCESS IN YOUR EARS !

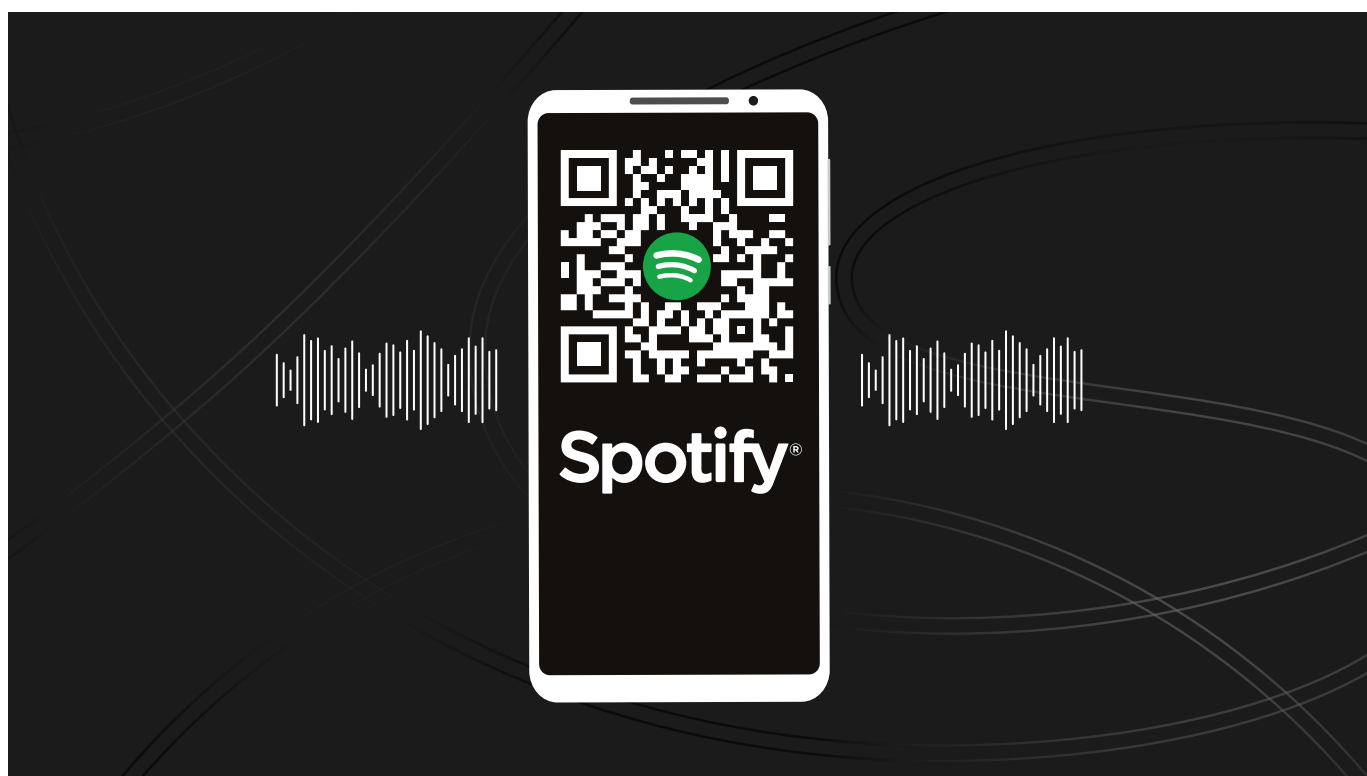

FOLLOW US !









